

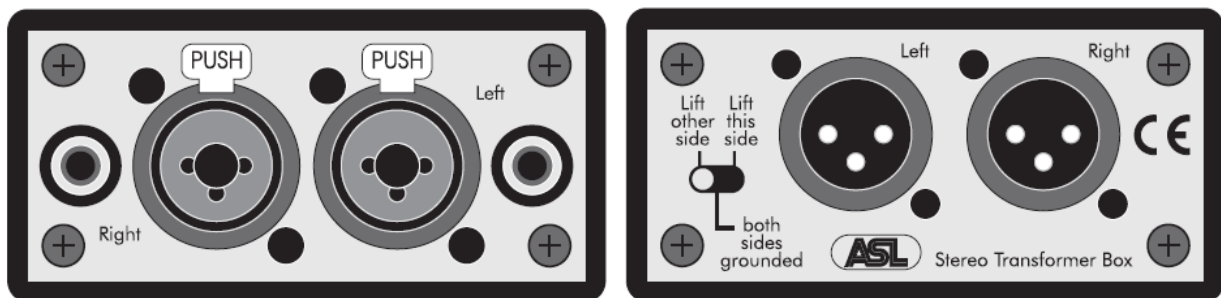

**TR-2**

## **DUAL CHANNEL TRANSFORMER BOX**



## **USER MANUAL**

**August 2016**

**This product is designed and manufactured by:**

ASL Intercom BV  
Zonnebaan 42  
3542 EG Utrecht  
The Netherlands  
Phone: +31 (0)30 2411901  
Fax: +31 (0)30 2667373  
Email: [info@asl-inter.com](mailto:info@asl-inter.com)  
Web: [www.asl-inter.com](http://www.asl-inter.com)

## INTRODUCTION

The TR-2 transformer box is equipped with 2 broadcast quality 600 : 600 ohm line transformers which can handle signal levels up to +24 dBu. There are various input and output connectors which makes this unit very versatile. Input or output ground may be lifted.

The transformers are housed in a strong metal box, covered with a plastic 'skin'. This ensures the box cannot make conductive contact with the metal housings of other equipment, possibly causing undesirable ground loops.

## APPLICATIONS

The TR-2 transformer box may be very useful when:

- Connecting ENG equipment to a sound reinforcement system
- Connecting a touring PA system to the 'house-PA'
- Distributing audio signals over long distances
- Connecting non-professional CD or cassette players to a professional audio system
- Connecting line outputs of instruments (keyboards) or backline equipment (amps) to a mixing console

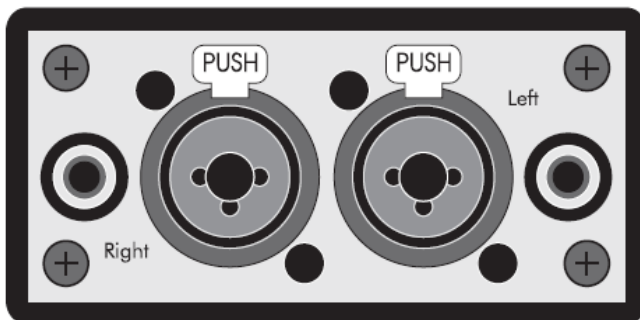

INPUT SIDE



OUTPUT SIDE

The input side of the TR-2 is equipped with one Neutrik Combo connector (1/4" stereo jack + XLR-3 female) and one RCA connector per channel. The Combo and RCA connector of one channel are paralleled. The output side is equipped with one XLR-3 male connector per channel.

Each transformer is placed between the input side and the output side. The presence of different connector types allows matching between different standards (e.g. RCA or jack to balanced XLR, or unbalanced XLR to balanced XLR).

The ground-lift switch on the output side has 3 positions. In the center position the 'grounds' of the connectors on both sides of the box are connected to the metal pieces of the box and to the screen of the transformers. In the left position of the switch the input side is ground lifted, in the right position the output side.

**NOTE:** The TR-2 transformer box is designed for low impedance (line level) signals. It can't be used for high impedance signals such as the ones from instrument pick-ups, in which case an active or passive DI-BOX should be used.

## TR-2 TECHNICAL SPECIFICATIONS

### Frequency Response

18 Hz – 50 kHz (+/- 0.25dB)  
(Load = 600  $\Omega$ , Source < 50  $\Omega$ , Input 0 dBu)

### Max Output Level

+ 24 dBu  
(THD < 1%,  $f = 50$  Hz, Source < 50  $\Omega$ , Load = 600  $\Omega$ )

### Total Harmonic Distortion (THD)

<0.2% at outputs levels up to 0 dBu  
<0.3% at output levels up to +10 dBu  
( $f = 20$  Hz – 20 kHz, Source < 50  $\Omega$ , Load = 600  $\Omega$ )

### Insertion Loss

2.1 dB  
(Load = 600  $\Omega$ , Source < 50  $\Omega$ )

### Common Mode Rejection Ratio

at 50 Hz: 95 dB  
at 1 kHz: 75 dB  
at 20 kHz: 45 dB  
(Load = 600  $\Omega$ , Source < 50  $\Omega$ )

### Dimensions

42 x 86 x 132 mm

### Weight

700 grams

*ASL reserves the right to alter specifications without prior notice.*

